

No. of Contacts	DIMENSIONS		REMARK (備註)
	A	B	
2	1.27	2.54	○
3	2.54	3.81	○
4	3.81	5.08	○
5	5.08	6.35	○
6	6.35	7.62	○
7	7.62	8.89	○
8	8.89	10.16	○
9	10.16	11.43	○
10	11.43	12.70	○
11	12.70	13.97	○
12	13.97	15.24	○
13	15.24	16.51	○
14	16.51	17.78	○
15	17.78	19.05	○
16	19.05	20.32	○
17	20.32	21.59	○
18	21.59	22.86	○
19	22.86	24.13	○
20	24.13	25.40	○
21	25.40	26.67	○
22	26.67	27.94	○
23	27.94	29.21	○
24	29.21	30.48	○
25	30.48	31.75	○
26	31.75	33.02	○
27	33.02	34.29	○
28	34.29	35.56	○
29	35.56	36.83	○
30	36.83	38.10	○
31	38.10	39.37	○
32	39.37	40.64	○

QC-XX-X-C/D/E
 Number of Contacts — | Contact Plating

Definition	Code
◎ Tin plated:	A
◎ Gold plated:	
flash B 15μ"	F
10μ" E 30μ"	J
◎ Duplex plating:	
flash K 15μ"	P
10μ" N 30μ"	U
◎ Standard:	K
◎ Prefix "V" means lead free plating.	

SPECIFICATIONS

Current Rating: 1 Amp
 Insulator resistance: 5000 Megohms min.
 Dielectric withstanding: AC 500 V
 Operating Temperature: -40°~+105°C
 Contact Material: Brass
 Insulator Material: High Temperature Thermoplastic, UL 94V-0 (Nylon-6T)
 Color: Black
 Finish: Tin, Gold or Duplex plated
 ◎ Standard: Duplex plated
 ◎ Note: Duplex plating: gold plated on contact area, Tin on solder area
 Harmful material should be compliant to Doc "EI-0005" Standards.

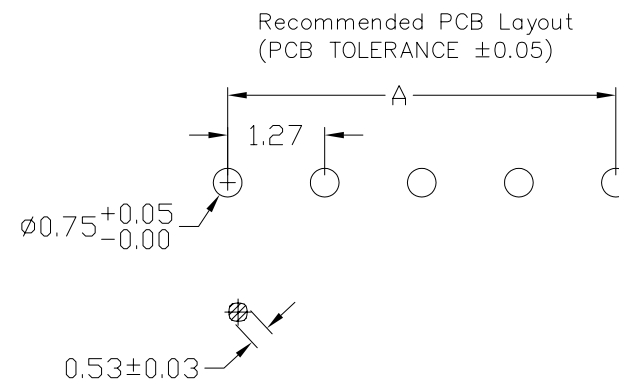
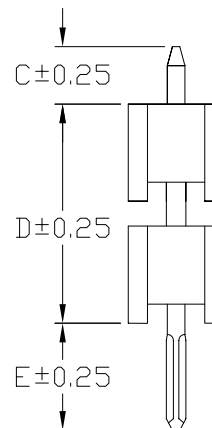
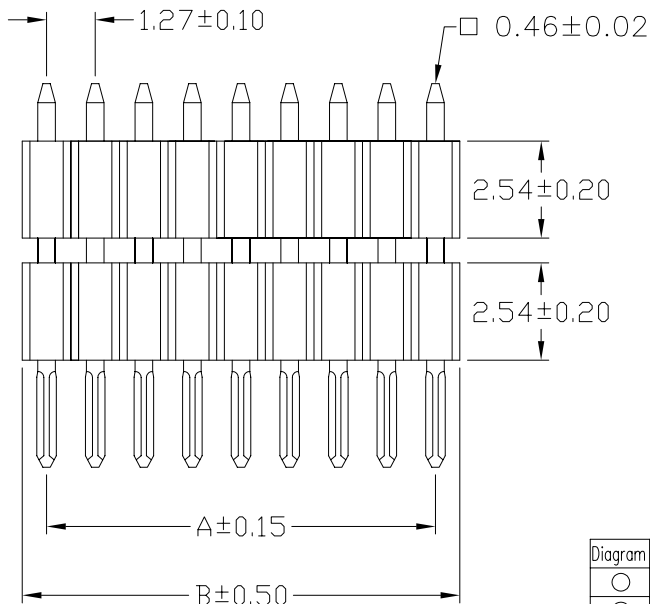
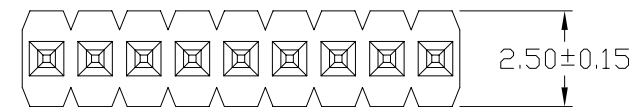

Diagram	Molding description	Rev.	ECN Number	Description	Drawn	Date
○	mass production & assemble mold	4	EC2-540406	新增規格	陳賜農	04/15' 05
◎	sample & assemble mold					
⊕	mass production & fix mold		EC2-540404	新增QC-XX-X-030/075/030	陳賜農	04/18' 05
⊗	sample & fix mold	5	EC3-630107	修改規格說明	詹益東	03/21 06'



GENERAL TOLERANCE	SCALE 1=1	ORIGINAL DRAWN 陳顯鑫	DATE 09/17/04'	DWG. NO.	TITLE	REV.
XX. ± 0.50	UNIT MM	CHECK 林錫錦	DATE 03/21 06'	F:\DWG\CDWG\C\CS1U.DWG	1.27mm BOARD STACKER (成品規格圖)	5
X. ± 0.30	SIZE A4	APPROVE 林錫錦	DATE 03/21 06'	PARTS NO. QC-XX-X-C/D/E		SHEET 1/2
.X ± 0.25						
.XX ± 0.20						

PARTS NO.	C	D	E	REMARK (備註)
QC-XX-X-060/055/020	6.00	5.50	2.00	
QC-XX-X-020/055/020	2.00	5.50	2.00	○
QC-XX-X-065/055/030	6.50	5.50	3.00	○
QC-XX-X-015/055/030	1.50	5.50	3.00	
QC-XX-X-028/055/021	2.80	5.50	2.10	
QC-XX-X-028/051/026	2.80	5.10	2.60	
QC-XX-X-028/055/021	2.80	5.50	2.10	
QC-XX-X-060/061/019	6.00	6.10	1.90	○
QC-XX-X-030/065/031	3.00	6.50	3.10	
QC-XX-X-028/104/046	2.80	10.40	4.60	
QC-XX-X-028/040/026	2.80	4.00	2.60	
QC-XX-X-028/047/026	2.80	4.70	2.60	○
QC-XX-X-015/050/026	1.50	5.00	2.60	○
QC-XX-X-028/058/026	2.80	5.80	2.60	○
QC-XX-X-028/053/026	2.80	5.30	2.60	
QC-XX-X-028/062/026	2.80	6.20	2.60	○
QC-XX-X-000/040/020	0.00	4.00	2.00	○
QC-XX-X-028/061/026	2.80	6.10	2.60	○
QC-XX-X-030/160/030	3.00	16.00	3.00	○
QC-XX-X-030/075/030	3.00	7.50	3.00	○



GENERAL TOLERANCE	
XX. ± 0.50	XXX. ±
X. ± 0.30	.XXX ±
.X ± 0.25	X.° ± 4°
.XX ± 0.20	.X° ± 4°

SCALE	1=1
UNIT	MM
SIZE	A4

ORIGINAL DRAWN	陳顯鑫
CHECK	林錫錦
APPROVE	林錫錦

DATE	09/17/04'
DATE	03/21 06'
DATE	03/21 06'

DWG. NO.	F:\DWG\CDWG\C\CS1U.DWG
PARTS NO.	QC-XX-X-C/D/E

TITLE	1.27mm BOARD STACKER (成品規格圖)
-------	------------------------------

REV.	5
SHEET	2/2